

Passive Submersible Transmitters

TM/N - Passive Level Transmitter



CUSTOMER BENEFITS

- Unreinforced output signal
- Fast customization thanks to configurable product design
- Short response times suitable for dynamic level measurements

Technical Specifications

PRESSURE MEASURING RANGE (MH2O)

	1 ... 5, (1)	> 5 ... 20	> 20 ... 250
Overpressure	3 bar	3 x FS (≥ 3 bar)	3 x FS
Burst pressure, (2)	> 200 bar	> 200 bar	> 200 bar
Accuracy, (3), (\pm % FS)	$\leq 0.5 / \leq 0.25$	$\leq 0.5 / \leq 0.25$	$\leq 0.5 / \leq 0.25$
Thermal shift (\pm % FS/ $^{\circ}$ C)			
Zero point 0...70 $^{\circ}$ C	≤ 0.06	≤ 0.03	≤ 0.015
Zero point -25...85 $^{\circ}$ C	≤ 0.08	≤ 0.04	≤ 0.02
Span 0...70 $^{\circ}$ C	≤ 0.015	≤ 0.015	≤ 0.015
Span -25...85 $^{\circ}$ C	≤ 0.02	≤ 0.02	≤ 0.02
Response time, (typ.)	< 0.1ms / 10...90% FS	< 0.1ms / 10...90% FS	< 0.1ms / 10...90% FS
Long term stability, (4)	< 0.5% FS / < 4 mbar	< 0.2% FS / < 4 mbar	< 0.1% FS / < 0.2% FS

(1) 0.5 mH2O on request

(2) Transducer

(3) Zero based accuracy according to DIN16086, incl. hysteresis and repeatability at ambient temperature

(4) 1 year (typ. / max.), the long term stability can be improved by ageing (burn-in) the sensor

TYPICAL OUTPUT SIGNAL (MH2O)

	1 ... 2	> 2 ... 4	> 4 ... 10
Output signal, (1), (mV)	15	25	35

	> 10 ... 20	> 20 ... 250
Output signal, (1), (mV)	50	100

(1) At nominal pressure, 10 V DC

ELECTRICAL SPECIFICATIONS

Circuit diagram

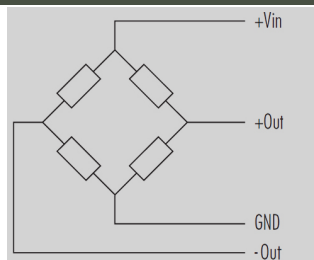

Input impedance	> 10 k Ω
Bridge resistance, (typ.)	3 k Ω
Supply voltage, (typ./max.)	10 / 15 V DC

PHYSICAL SPECIFICATIONS

Materials	
Transducer	Stainless steel (316L / 1.4435), titanium (Gr. 2), (1)
Housing	Stainless steel (316L / 1.4404), titanium (Gr. 2)
Seals	Viton (Standard), EPDM, Kalrez
Cable	PUR, FEP, PE
Weight (2)	200 g

(1) Hastelloy (C-276) on request

(2) Specification for a TM/N, closed, cable

Equipment

OVERVIEW

10.00.0091	Accessories overview

Additional documents

OPERATING AND SAFETY INSTRUCTIONS

Article number	
10.88.0369	DMM030

Ordering information

	X.	XXXX.	XXXX.	XX.	XXX
Type					
	TM/N	22			
Pressure type					
	Gauge	1			
	Absolute (vacuum)	2			
Pressure measuring range					
	50 mbar ... < 100 mbar	XX			
	100 mbar ... < 25 bar	XX			
	Offset, special adjustment	99			
Process connection					
	Closed, (Fig.1)	55			
	Open, (Fig.2)	56			
	G 1/4 M, (Fig. 3)	11			
	G 1/2 M, (Fig. 3)	13			
	Customized connections available	99			
Electrical connection					
	Connectable version, IP 68, (Fig. 4)	07			
	PE cable, IP 68, black, (5), (6)	13			
	PUR cable, IP 68, black (4), (6)	15			
	FEP cable, (high temperature), black, IP 68, (5), (12)	12			
	FEP cable, IP 68, black (6)	21			
Output signal					
	0...15 mV (11)	10			
	0...25 mV (11)	11			
	0...35 mV (11)	12			
	0...50 mV (11)	13			
	0...100 mV (11)	14			
	0...XXX mV (customized)	99			
Accuracy					
	$\leq \pm 0.5$ % FS	0			
	$\leq \pm 0.25$ % FS (on request)	1			
Temperature range					
	-5...50 °C compensated process temperature: -5...50 °C	(allowed)	4		
	-5...80 °C compensated process temperature: -5...80 °C (5)	(allowed)	5		
	Customized		9		
Option 1					
	Special oil filling: Androl Food food applications)	(for		G	
Option 2					
	Electronics packed in gel: Gauge pressure			C	
	Electronics packed in gel: Absolute pressure			D	
Option 3					
	Ballast weight 1.4435			B	
	Version titanium (without ballast weight)			K	
	Seals: Viton (standard)			U	
	Seals: EPDM			S	

Seals: Kalrez (8)			T
Humidity filter element for gauge versions (only for PUR and PE cable)			Z
Cutting ring connection G1/2 male			
Strain relief			

(4) For operating temperature > 50°C, PE or FEP cable must be used

(5) Cable type PE and FEP pressure range <10 bar

(6) Specify type and length of cable and medium

(8) Only with FEP cable available

(11) According to datasheet

(12) max. 130°C @ 10 mH2O, max. 110°C @ 50 mH2O

Technical drawings

Dimensions

Fig. 1: Closed version

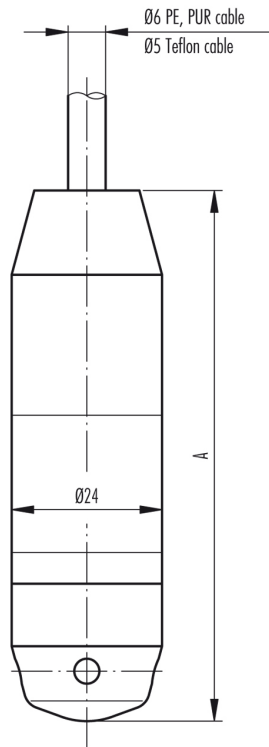

Fig. 2: Open version

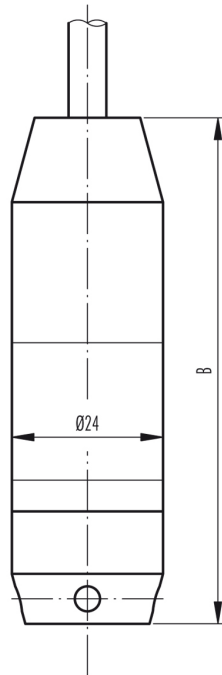

Fig. 3: with process connection

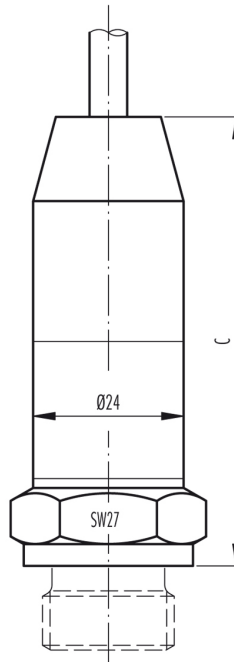
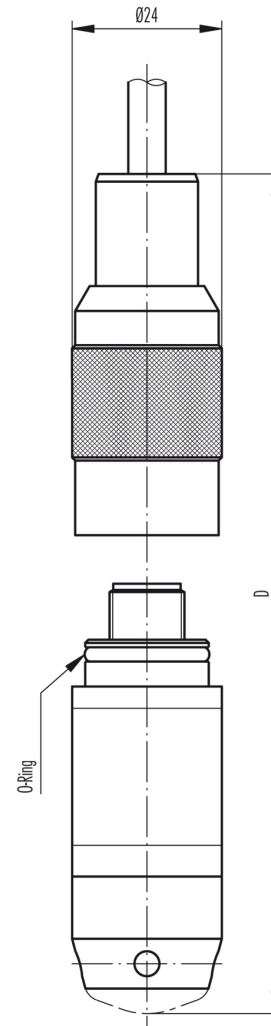

Fig. 4: Electrical connection, connectable



	A [mm]	B [mm]	C [mm]	D [mm]	Weight [g]
without ballast weight	85	81	on request	on request	approx. 200
with ballast weight	172	168	on request	on request	approx. 450

Colour

white	+Vin
yellow	GND
brown	+Out
green	-Out

SCIGATE
Your Automation Partner

SCIGATE AUTOMATION (S) PTE LTD
No.1 Bukit Batok Street 22 #01-01 Singapore 659592
Tel: (65) 6561 0488 Fax: (65) 6562 0588
Email: sales@scigate.com.sg Web: www.scigate.com.sg
Business Hours: Monday - Friday 8.30am - 6.15pm

Specifications may change without notice.

ST5 Headquarters, Switzerland:
ST5 Sensor Technik, Sirmach AG
Rütihofstrasse 8 | 8370 Sirmach | Switzerland
sales@st5sensors.com | www.st5sensors.com

ST5 China:
ST5 Sensor Technology (Shanghai) Co. Ltd
Room 2603-2606 | North Building, Fortune | 108 Square
Lane 1839 | Qixin Road | Minhang District | Shanghai | China
sales@st5sensors.com | www.st5sensors.com.cn

ST5 France:
ST5 France
844 Route de la Caille | 74350 Allonziere la Caille | France
info-fr@st5sensors.com | www.st5sensors.fr

ST5 Germany:
ST5 Sensoren Transmitter Systeme GmbH
Poststrasse 7 | 71063 Sindelfingen | Germany
info-de@st5sensors.com | www.st5sensors.de

ST5 Great Britain:
ST5 Great Britain Ltd.
Box 3942 | Warwick | CV34 9AE | United Kingdom
contact@st5sensors.com | www.st5sensors.co.uk

ST5 Italy:
ST5 Italia s.r.l.
Via Lambro 36 | 20090 Opera (MI) | Italy
info-italia@st5sensors.com | www.st5sensors.it